

Plots 36-38

3 BED / 6 PERSON 145.2 m²

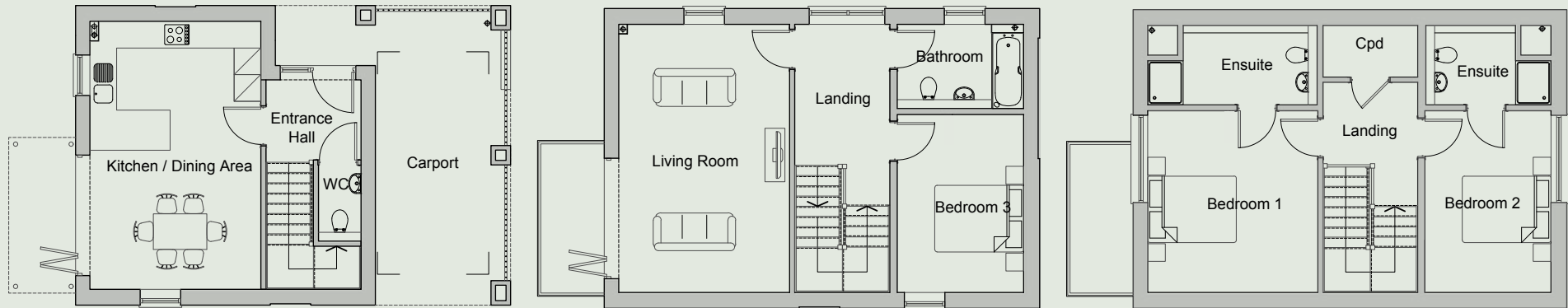

Ground Floor

Kitchen / Dining	3.9m x 6.0m	12.8" x 19.7"
Entrance Hall	2.1m x 1.9m	6.9" x 6.2"
Carport	2.6m x 6.6m	8.5" x 21.7"

First Floor

Living Room	3.9m x 6.0m	12.8" x 19.7"
Bathroom	2.8m x 1.9m	9.2" x 6.2"
Bedroom 3	2.8m x 4.0m	9.2" x 13.1"

Second Floor

Bedroom 1	3.8m x 4.1m	12.5" x 13.5"
Bedroom 2	2.8m x 4.1m	9.2" x 13.5"